

SALLYPORT

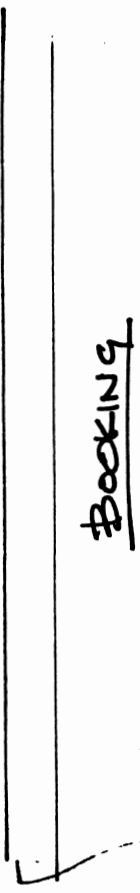

VEHICLE
SALLYPORT

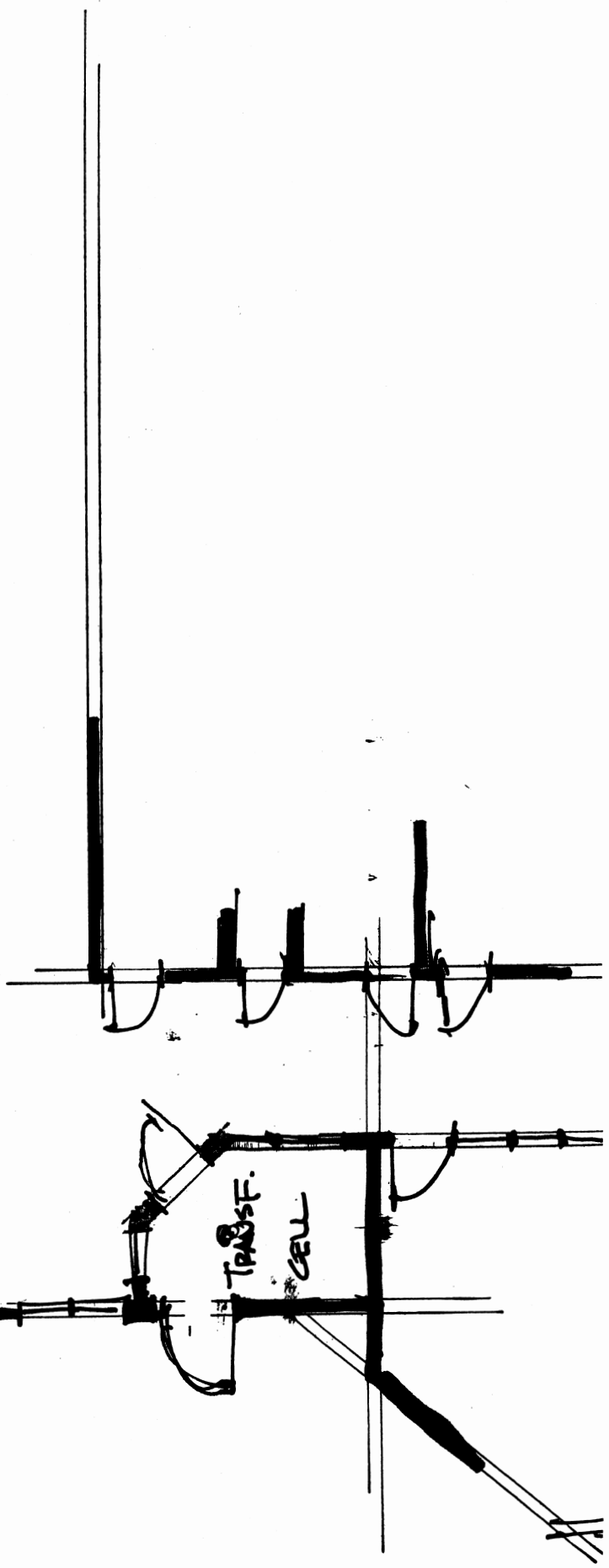

TRANSF.
CELL

**Howard County Criminal Justice Center Remodel
Facility Improvements**

Probable Cost Estimate

SUMMARY

		%	Cost/GSF	Cost
Substructure		0.00%	\$ -	-
Structural Frame		0.00%	\$ -	-
Roofing		0.00%	\$ -	-
Exterior Walls		0.19%	\$ 0.46	1,200
Interior Subdivision		27.38%	\$ 67.76	176,173
Vertical Circulation		0.00%	\$ -	-
Wall Finishes		0.21%	\$ 0.51	1,320
Floor Finishes		1.15%	\$ 2.86	7,425
Ceiling Finishes		0.31%	\$ 0.77	2,000
Millwork and Specialties		0.00%	\$ -	-
Casework		0.00%	\$ -	-
Equipment		51.99%	\$ 128.65	334,500
Security/Surveillance Equipment				Included Above
Mechanical - Fire Protection		0.00%	\$ -	-
- Plumbing		0.00%	\$ -	-
- HVAC		0.00%	\$ -	-
Electrical (Excluding Security/Surveillance Systems)		0.60%	\$ 1.48	3,850
Site Development - allowance		0.00%	\$ -	-
		81.83%	\$ 202.49	526,468
General Conditions (Includes Bonds)			\$ -	-
General Contractor's Overhead & Profit	10.00%	8.18%	\$ 20.25	52,647
Contractor's Performance & Payment Bonds	1.00%	0.90%	\$ 2.23	5,791
SUB TOTAL CONSTRUCTION COST		90.91%	\$ 224.96	584,905
Design Contingency	10.00%	9.09%	\$ 22.50	58,491
TOTAL CONSTRUCTION COSTS		100.00%	\$ 247.46	\$ 643,396

SUBSTRUCTURE

Continuous Wall Footings:

Concrete wall footings	-	CY	145.00	-
Formwork to wall footings	-	LF	8.95	-
Concrete trench footings	-	CY	145.00	-
Steps & misc	-	LS	1,000.00	-
Reinforcing steel	-	TON	1,935.00	-

Concrete Foundation Walls & Grade Beams:

N/A

Masonry Foundation Walls:

Grouted masonry foundation walls - 6" thick	-	SF	10.05	-
Grouted masonry foundation walls - 8" thick	-	SF	11.45	-

Concrete Column Bases & Piers:

Concrete column bases	-	CY	162.75	-
Formwork to concrete column bases	-	SF	12.40	-
Concrete piers	-	CY	170.50	-
Formwork to piers	-	SF	14.85	-
Reinforcing steel	-	TON	1,935.00	-

Slab On Grade:

Concrete slab on grade (5")	-	CY	140.00	-
Slab thickenings	-	CY	140.00	-
Slab forming, finishing and curing	-	SF	0.85	-
Welded wire mesh	-	SF	0.39	-
Reinforcing steel	-	TON	1,860.00	-
Vapor barrier	-	SF	0.14	-

N/A

6" compacted granular fill	-	CY	26.50	-
----------------------------	---	----	-------	---

Foundation Thermal & Moisture Protection:

1/2"x5" expansion strip	-	LF	1.40	-
Perimeter insulation	-	SF	1.70	-
Basement waterproofing/insulation				N/A

Earthwork:

Foundation excavation	-	CY	4.75	-
Backfilling - excavated material	-	CY	8.00	-
Backfilling - imported granular material	-	CY	26.50	-
Load/remove excess soil	-	CY	6.50	-
Miscellaneous foundation excavation/backfilling	-	LS	1,000.00	-

STRUCTURAL FRAME

Floor Frame:

Structural tube steel columns	-	TON	1,800.00	-
Structural steel beams, channels and angles	-	TON	1,600.00	-
Connections and miscellaneous steel	-	TON	1,600.00	-
Baseplates and anchor bolts				Included
Steel erection	-	SF	1.60	-

STRUCTURAL FRAME - Continued

Cast In Place Concrete:

8" precast concrete deck	-	SF	8.00	-
Concrete topping on structural deck	-	CY	200.00	-
Slab forming, finishing and curing	-	SF	0.85	-
Welded wire mesh				N/A

Roof Frame:

Structural tube steel columns	-	TON	1,800.00	-
Structural steel beams, channels and angles	-	TON	1,650.00	-
Fire rated concrete/steel columns				N/A
Baseplates and anchor bolts	-	EA	155.00	-
Connections and miscellaneous steel	-	TON	1,650.00	-
Open web steel joists	-	TON	1,150.00	-
1.5" - 20 gauge galvanized metal roof deck	-	SF	0.95	-
Steel erection	-	SF	1.20	-

8" precast concrete plank	-	SF	8.00	-
---------------------------	---	----	------	---

Fireproofing/Coatings:

Add for structural fireproofing	-	SF	3.00	-
				-

ROOFING

EPDM Roofing Systems:

Thermoplastic membrane roofing	-	SF	2.25	-
4" insulation	-	SF	2.10	-
Add for tapered insulation	-	SF	2.00	-
Edge flashing	-	LF	5.00	-
Drip edge/gravel stop	-	LF	12.00	-
Counterflashing	-	LF	9.20	-
Flash roof drains	-	EA	60.00	-
Roof expansion joint				N/A
Miscellaneous sheet metal and flashings	-	LS	500.00	-
Prefinished metal copings - 8"	-	LF	23.00	-
Prefinished metal copings - 14"	-	LF	26.50	-
Treated wood blocking	-	LF	8.50	-
Metal fascia/backing	-	LF	12.00	-
Prefinished metal gutters	-	LF	11.00	-
Prefinished metal downspouts	-	LF	11.00	-
Splash blocks	-	EA	40.00	-

Skylights:

Prefinished aluminum framed skylights	-	EA	2,500.00	-
				-

EXTERIOR WALLS

Face brick veneer - utility size	-	SF	-	-
Split face concrete block veneer	-	SF	9.35	-
Add for accent concrete block veneer - 20% allowance	-	SF	5.00	-
Miscellaneous masonry veneer detailing	-	LS	2,500.00	-
8" concrete block back up	-	SF	8.55	-
Add for 8" bond beams	-	LF	6.00	-
Add for grouting block cores	-	SF	3.20	-
Masonry reinforcing steel	-	TON	800.00	-
2" rigid insulation	-	SF	1.15	-
Masonry flashings	-	SF	2.60	-
Caulking and sealants	1	LS	1,200.00	1,200

Exterior Framed Construction:

Metal wall panel	-	SF	16.00	-
Prefinished metal soffits	-	SF	10.00	-
Cement plaster soffits and framing	-	SF	10.00	-
Metal stud backup	-	SF	3.00	-
Sprayed-on insulation at roof deck	-		-	-
Miscellaneous iron and rough carpentry	-	SF	0.30	-

Prefinished Aluminum Entry Doors, Frames & Windows:

Prefinished aluminum storefront	-	SF	36.00	-
Prefinished aluminum windows - bullet proof	-			-
Prefinished aluminum windows	-	SF	52.00	-
Cell security windows	-	SF	-	-
Window security grilles	-		-	-
Aluminum entrance doors and frames	-	EA	1,900.00	-
Aluminum entrance doors and frames	-	PR	3,600.00	-

Insulated Hollow Metal Doors, Frames & Hardware:

Insulated hollow metal doors, frames & hardware	-	EA	1,500.00	-
Insulated hollow metal doors, frames & hardware	-	PR	2,600.00	-

Overhead Doors & Frames:

Insulated overhead door 10'x10'	-	EA	2,500.00	-
Insulated overhead door 22'x12'	-	EA	6,000.00	-
Steel channel frames	-	EA	600.00	-
Power operators	-	EA	800.00	-

Miscellaneous Building Specialties:

Security fence - courtyard 16' high	-	LF	145.00	-
Security fence top - courtyard	-	SF	35.00	-
Mechanical screens - rooftop units	-	SF	35.00	-
Surface applied front signage - allowance	-		-	-

1,200

INTERIOR SUBDIVISION

Interior Masonry:

6" concrete block partitions	-	SF	8.30	-
Add for 6" bond beams	-	LF	6.00	-
8" concrete block partitions	340	SF	8.55	2,907
Add for 8" bond beams	250	LF	6.75	1,688
Add for grout fill masonry cores	340	SF	3.20	1,088
12" concrete block partitions	-			-
Masonry reinforcing steel	1	TON	800.00	400
Miscellaneous iron & rough carpentry	180	SF	0.50	90

Metal Stud & Drywall:

4" metal stud w/GWB both sides - 10'	-	LF	45.00	-
4" metal stud w/GWB one sides - 10'	-	LF	30.50	-
Add for abuse resistant drywall				N/A
Sound attenuation insulation	-	SF	0.85	-
Fire safing/sealing - allowance	-	LS	2,000.00	-

Interior Glazing Systems:

Aluminum entrance doors and frames	-	EA	2,000.00	-
Aluminum framed storefront	-	SF	36.00	-
Interior windows - secure/ one way visibility	320	SF	100.00	32,000
Interior windows - non-contact visitation	-	SF	30.00	-

Interior Doors Frames & Hardware:

Hollow metal frames 2'0"x7'0"	-	EA	140.00	-
Hollow metal frames 2'6"x7'0"	-	EA	145.00	-
Hollow metal frames 3'0"x7'0"	-	EA	147.25	-
Hollow metal frames 5'0"x7'0"	-	EA	155.00	-
Hollow metal frames 6'0"x7'0"	-	EA	160.00	-
Hollow metal frames 8'0"x7'0"	-	EA	175.00	-
Hollow metal doors 2'0"x7'0"	-	EA	232.50	-
Hollow metal doors 2'6"x7'0"	-	EA	277.70	-
Hollow metal doors 3'0"x7'0"	-	EA	333.25	-
Hollow metal doors 4'0"x7'0"	-	EA	440.00	-
Solid core wood doors - 2'5"x7'0"	-	EA	225.00	-
Solid core wood doors - 3'0"x7'0"	-	EA	255.00	-
Standard hardware	-	LS	-	-
Labor to install doors & frames	-	EA	350.00	-

Interior Glazing:

Interior windows - secure/one way visablity	-	SF		
Interior windows - non-contact visitation	-	SF		
Observation window - 12sf	4	EA	900.00	3,600

Security Screens:

Cell mezzanine walkway enclosure - painted	3,360	SF	40.00	134,400
Add for cell mezzanine access gates - painted	-	EA	400.00	-

176,173

VERTICAL CIRCULATION

Elevators:				N/A
Stairs (Including Handrails):				
Cell mezzanine access stairs - painted	-	EA	5,500.00	-
Building support access stairs - 3'4" treads/1ft	-	EA	4,850.00	-
Concrete fill stair pans	-	CY	200.00	-
Ladders:				
Roof access ladder	-	EA	1,200.00	-
Handrails & Railings:				
Floor mounted guardrail	-	LF	65.00	-
				<hr/>
				-

WALL FINISHES

Painting & Wallcovering:				
Vinyl fabric wall covering				N/A
Paint drywall	-	SF	0.45	-
Paint concrete block	600	SF	0.70	420
Epoxy paint concrete block	-	SF	1.40	-
Stain/paint doors & frames	-	EA	85.00	-
Paint interior window frames	100	SF	4.00	400
Paint metal pan stairways	-	EA	450.00	-
Paint roof access ladder	-	EA	200.00	-
Miscellaneous painting & finishing	1	LS	500.00	500
Tile:				
Acoustical/Tackable Wall Treatment:				
				<hr/>
				1,320

FLOOR FINISHES

Resilient Flooring:				
Carpet	-	SY	25.00	-
Vinyl composition tile	-	SF	1.85	-
Rubber floor	-	SF	6.50	-
Resilient base	-	LF	1.55	-
Resilient treads and nosings				N/A
Elevated Access Floor:				
Central control room raised floor	-	SF	12.00	-
Satellite control room raised floor	300	SF	12.00	3,600
Add for risers	12	EA	300.00	3,600

FLOOR FINISHES - Continued

Tile & Terrazzo:

Quarry tile	-	SF	7.25	-
Quarry tile base	-	LF	7.25	-
Ceramic mosaic floor tile				N/A

Floor Coatings & Sealers:

Epoxy floor sealer - trowelled				N/A
Sealed concrete	180	SF	1.25	225
				7,425

CEILING FINISHES

Acoustic Tile:

Suspended acoustic tile ceiling 2x2	-	SF	2.25	-
Suspended acoustic tile ceiling 2x4	-	SF	1.85	-
Suspended acoustic tile ceiling - washable	-	SF	2.80	-

Drywall Ceilings:

Suspended drywall ceilings				N/A
Drywall soffits/bulkheads - allowance	-	LS	5,000.00	-

Ceiling Painting/Coatings:

Paint drywall and plaster - bulkheads allowance	1	LS	2,000.00	2,000
Epoxy paint drywall and plaster				N/A
Paint exposed ceilings	-	SF	0.90	-
				2,000

MILLWORK & SPECIALITIES

Toilet Partitions - Solid Plastic:

Toilet partitions	-	EA	1,100.00	-
Toilet partitions - handicap	-	EA	1,200.00	-
Urinal Screens				

FIRE PROTECTION

Automatic sprinkler system	-	SF	2.50	-
Pressure booster pumps	-	LS	45,000.00	-
				-

PLUMBING

Cold/Hot Water Service:

Water service entry	-	LS	5,800.00	-
Reduced pressure backflow preventer				Included
Triplex booster pump assembly	-	LS	15,500.00	-
Hot water heaters/storage	-	LS	10,000.00	-
Gas water heater				Included
Hot water storage tank				Included
Expansion tanks	-	EA	650.00	-
Hot water recirculation pump	-	EA	895.00	-
Water softening system	-	LS	8,500.00	-

Plumbing Fixtures (Including Rough-in)

Water closets - wall hung	-	EA	1,080.00	-
Urinals - standard	-	EA	990.00	-
Wall hung lavs	-	EA	980.00	-
Countertop lavs	-	EA	705.00	-
Electric water coolers	-	EA	1,185.00	-
Stainless steel sinks - single bowl	-	EA	926.00	-
Stainless steel sinks - double bowl	-	EA	1,165.00	-
Floor sinks	-	EA	1,050.00	-
Showers	-	EA	1,800.00	-
Wall hydrants	-	EA	320.00	-
Washer connection box	-	EA	110.00	-
Water closets - Security	-	EA	2,000.00	-
Water closets/lav - Security	-	EA	3,500.00	-
Water closets/lav - (handicap) Security	-	EA	3,500.00	-
Wall hung lavs Security	-	EA	1,200.00	-
Showers units Security	-	EA	2,500.00	-
Shower heads, controls, drains	-	EA	1,200.00	-
Time-limiting pushbuttons	-	EA	125.00	-
Thermostatic mixing valves	-	EA	225.00	-

Piping:

Domestic water, waste, and vent connections	-	EA	2,000.00	-
<i>Domestic Water Piping - Type L Copper:</i>				
Domestic water piping				Included
Water hammer arrestors				Included
Miscellaneous valves, accessories, trim				Included
Pipe insulation - fiberglass 1" wall thickness				Included

MILLWORK & SPECIALITIES - Continued

Toilet Accessories - Stainless Steel:

Toilet paper holder	-	EA	69.75	-
Grab bars	-	EA	100.75	-
Grab bars - cell area	-	EA	110.00	-
Framed glass mirrors 24"x36"	-	EA	178.25	-
Framed glass mirrors 48"x36"	-	EA	355.00	-
Framed glass mirrors 60"x36"	-	EA	457.25	-
24"x36" mirrors - cells	-	EA		-
Soap dispenser	-	EA	96.10	-
Soap dish	-			-
Towel dispenser - recessed	-	EA	255.00	-
Specimen pass through cabinet	-	EA	240.00	-
Towel dispenser/waste receptacle	-			-
Waste receptacle	-	EA	325.50	-
Napkin disposal	-			-
Clothes hooks - standard	-			-
Mop strips	-	EA	131.75	-
Shower seats	-	EA	365.00	-
Shower seats - cell	-	EA	365.00	-
Shower grab bars	-	EA	175.00	-
Shower grab bars - cell	-	EA	220.00	-

Interior Signage & Directories:

Interior signage - allowance	-	LS	500.00	-
Dedication plaque	-	LS	1,500.00	-

Miscellaneous Building Specialties:

Fire extinguishers and cabinets	-	EA	450.00	-
Recessed floor mats	-			-
Interior window sills	-			-
Coat rod & shelf	-	LF	31.00	-
Cubicle curtain and track	-	LF	65.00	-
TV brackets	-	EA	400.00	-
Pencil drawer	-	EA		-
Transaction drawer	-	EA		-

Millwork/Wood Trim:

Miscellaneous finished carpentry/trim	-	LS	5,000.00	-
---------------------------------------	---	----	----------	---

Lockers:

Staff lockers - 18"x12"	-	EA	225.00	-
Staff lockers - 18"x24"	-	EA	250.00	-
Key cabinet	-	EA	120.00	-

American Structurepoint

CASEWORK

Base cabinets and tops	-	LF	140.00	-
Road officers work stations	-	LF	85.00	-
Road officers work stations dividers	-	EA		-
Wall cabinet	-	LF	90.00	-
Tall storage cabinet - 36"x24"	-	EA	675.00	-
Tall storage cabinet - 48"x30"	-	EA	1,000.00	-
Tall storage cabinet - 36"x36"	-	EA	850.00	-
Bathroom vanity top - solid surface	-	LF	125.00	-
Reception desks	-	LF	300.00	-
Secretary pass thru ledge - 24" wide	-	LF	30.00	-
Booking desk	-	LF	250.00	-
Dispatch room pass thru slots	-	EA	60.00	-
	-	EA	-	-
Central control casework	-	LS	20,000.00	-
Dentention control casework	-	LS	15,000.00	-
Miscellaneous casework and shelving	-	LS	10,000.00	-
				<hr/>

EQUIPMENT

Detention/Security Equipment (From Security Eq Page)		See	Security Page	56,500
Touchscreen Control System Upgrade	1	LS	275,000.00	275,000
Security Door Control System	3	EA	1,000.00	3,000

Misc. Detention Furnishings

	-			-
	-	LS	30,000.00	-
Metal Detectors	-	EA	8,500.00	-
	-	SF	25.00	-
	-			-
	-	EA	400.00	-
	-	EA	650.00	-
Inmate telephone stands				-
	-	EA	80.00	-

Food Service Equipment

Food service equipment - allowance	-	SF	4.00	-
------------------------------------	---	----	------	---

Visual Display Boards/Projection Screens:

Markerboards - 4' high	-	LF	65.00	-
Tackboards - 4' high	-	LF	45.00	-
Tackable surface - 10"	-	LF	6.00	-
72" projection screens - manual	-	EA	320.00	-

Miscellaneous Equipment:

Loading dock equipment	-	LS	3,500.00	-
------------------------	---	----	----------	---

334,500

PLUMBING - Continued

Sanitary Waste & Vent - Cast Iron:

Waste piping				Included
Underground waste piping				Included
Trench excavation and backfilling for underground piping				Included
Sanitary cleanouts and tees				Included
Floor drains - cells	-	EA	525.00	-
Floor drains - day rooms	-	EA	525.00	-
Floor drains - indoor exercise area	-	EA	525.00	-
Floor drains - equipment rooms	-	EA	300.00	-
Floor drains - kitchen	-	EA	300.00	-

Elevator sump pump assembly				N/A
Oil interceptor				N/A

Storm Water Removal:

Roof drains/overflow drains 3"/4" cast iron	-	EA	4,000.00	-
Storm water piping				Included
Trench excavation and backfilling for underground piping				Included
Insulation for horizontal pipe				Included
Storm cleanouts and tees				Included

Gas Piping:

Gas piping and accessories	-	SF	0.35	-
Meter				
Valves and pressure regulators				

Miscellaneous Plumbing:

Pipe ID, testing and tagging	-	LS	1,000.00	-
				-

HVAC

Hydronic heating Equipment & Distribution

Boiler, accessories, pumps and piping	-	SF	3.00	-
Perimeter heating	-	LF	85.00	-

HVAC Equipment & Distribution: Administration Area

Technology equipment room HVAC equipment	-	LS	10,500.00	-
Rooftop air handling units	-	LS	36,000.00	-
Cabinet Heaters	-	EA	880.00	-
Terminal boxes	-	EA	700.00	-
Ductwork - galvanized	-	LBS	4.00	-
Dampers and duct accessories	-	LS	10,000.00	-
Duct insulation	-	SF	1.95	-
Supply air diffusers - standard	-	EA	130.00	-
Return/exhaust air grilles - standard	-	EA	85.00	-
Louvers	-			-
Building exhaust/relief air systems	-	SF	0.40	-

HVAC - Continued

Air Handling Equipment & Distribution: Secured Area

Multi-zone rooftop air handling units	-	LS	12,000.00	-
Air cooled condensing units	-	EA		Included
Refrigerant piping	-	LS		Included
Unit heaters	-	EA	625.00	-
Ductwork - galvanized	-	LBS	4.00	-
Dampers and duct accessories	-	LS	1,200.00	-
Duct insulation	-	SF	1.95	-
Supply air diffusers - standard	-	EA	130.00	-
Supply air diffusers - secure	-	EA	225.00	-
Return/exhaust air grilles - standard	-	EA	85.00	-
Return/exhaust air grilles - secure	-	EA	120.00	-
Louvers	-	LS	5,000.00	-
Building exhaust/relief air systems	-	SF	0.35	-

Temperature Control, Testing & Balancing:

Air test and balance	-	LS	1,200.00	-
Water test and balance	-	LS	500.00	-
Temperature control system	-	SF	2.00	-

ELECTRICAL

Electrical Service Entry:

Service entry	-	LS	12,000.00	-
Main service panel 1,600 amp 480/277v	-	EA	22,000.00	-
Feeders	-	LF	65.00	-
Distribution Panels:				
400/800 amp 480/277v	-	EA	4,500.00	-
Branch Panels:				
208/120v 3phase 4 wire	-	EA	2,300.00	-
480/277 3phase 4 wire mlo	-	EA	3,760.00	-
Panel feeders	-	LF	25.00	-
TVSS - internal	-	EA	650.00	-
Transformers	-	EA	5,400.00	-

Emergency Power Systems:

Emergency generator - 600 kw	-	EA	123,000.00	-
Automatic transfer switch 800A/4p	-			-
Automatic transfer switch 400A/4p	-			-
Fuel tank	-			-
Emergency panels	-	EA	2,300.00	-
UPS system	-	LS	40,000.00	-
Feeders	-	LF	35.00	-

Branch Power Distribution:

Branch power distribution	-	SF	2.00	-
---------------------------	---	----	------	---

Mechanical/Equipment Connections:

Mechanical/equipment connections	-	LS	85,000.00	-
Kitchen electrical connections	-	LS	20,000.00	-

ELECTRICAL - Continued

Lighting:

Detention area - 4' surface-mounted max. security fluor.	400	SF	6.00	2,400
General area - 2x4 fluorescent w/duel level switching	-	SF	3.30	-
Private offices/conference - pendant linear indirect	-	SF	5.00	-
Toilet areas - linear wall slot fluorescent fixtures	-	SF	4.75	-
Utility spaces - pendant-mounted industrial-type	-	SF	2.80	-
Outdoor lighting - allowance				-
Exit lights	1	EA	250.00	250
Single pole switches	-	EA	100.00	-
Three-way switches	-	EA	110.00	-
Electric eye for overhead door	-	EA	350.00	-
On-Off push button w/pilot light	-	EA	130.00	-
Lighting controls	1	LS	1,200.00	1,200

Fire Alarm System:

Fire alarm system	-	SF	1.50	-
Fire alarm control panel				Included
Annunciator panel				Included
Detection devices				Included
Warning devices				Included
Sprinkler system interface/contols				Included
Conduit and wiring				Included

Sound Systems:

Sound systems	-	SF	1.00	-
Conduit and wiring	-	SF	0.30	-

Miscellaneous Special Systems:

Data systems rough-in	-	SF	0.40	-
Data systems conduit and wiring				NIC
Security/surveillance systems rough-in	-	SF	0.65	-
Security/surveillance systems conduit and wiring			Included In	Security Equipment Estimate

3,850

SITE DEVELOPMENT

**Howard County Criminal Justice Center
Kokomo, IN**

Schematic Design Construction Cost Projections

DETENTION/SURVEILLANCE EQUIPMENT

Detention/Security Equipment:

Security doors, frames, hardware	7	EA	4,500.00	31,500
Security doors, frames, hardware-cells	-	EA	5,500.00	-
Security doors, frames, hardware-exterior	-	EA	4,000.00	-
				-
				-
				-
				-
Security/Surveillance equipment	1	LS	25,000.00	25,000
				-
				-
Property room pass thru ledges	-	ea	250.00	-
Precast concrete cell assemblies - single	-	EA	10,000.00	-
Precast concrete cell assemblies - double	-	EA	15,000.00	-
Steel cell assemblies - single	-	EA	16,000.00	-
Steel cell assemblies - double	-	EA	22,000.00	-
Misc. bunks	-	EA	350.00	-
Holding cell bunks	-	EA	350.00	-
Group hold bunks	-	LF		-
Dorm bunks	-	EA	350.00	-
Cell bunks	-	EA	350.00	-
Cell tables	-	EA	250.00	-
Cell desk/writing surface	-			-
				-
				-
Padded cell wall material	-	SF	25.00	-
Booking platform rest ledge - 4'4" high	-	LF	-	-
		EA	240.00	-
Dorm bunks dividers - 6'4"	-	EA	-	-
Dorm bunks dividers - 2'8"	-	EA	-	-
Clothes hooks	-			-
Dayroom visitation bench and stools	-	EA	230.00	-
Dayroom visitation bench	-	EA	230.00	-
Release dorm visitation bench and stools	-	EA	450.00	-
Release dorm visitation bench	-	EA	450.00	-
Dorm lockers	-	EA		-
Television stand	-			-
Dayroom tables 8'0" metal	-	EA	2,000.00	-
Dayroom tables 4'0" metal	-	EA	2,500.00	-
Dayroom tables w/ 4 stools	-	EA	3,000.00	-
Release dorm tables with 4 stools	-	EA	3,400.00	-
Dayroom tables w/ 6 stools	-	EA	5,000.00	-
Evidence lockers	-	LS	-	-
Gun lockers	-	EA	2,500.00	-
Knife cabinet	-	EA	650.00	-

American Structurepoint

Inmate telephone stands	-	EA		-
Basketball goals	-	EA		-
Basketball court striping	-	LS		-
	-	EA	-	-
Night depository	-	EA	8,500.00	-
	-		-	-
Video visitation booths	-	EA	6,500.00	-
Video visitation equipment allowance	-	LS	4,000.00	-
Security automation equipment	-	LS		-
Person to person visitation booths	-	EA		-

Security Equipment Total	56,500
---------------------------------	---------------

Misc. Security System:

Covert microphone	EA	-	-
Covert camera	EA	-	-
Add for motorized/controlled door	EA	-	-
Add for monitored only door	EA	-	-
Intercom staff station	EA	-	-
Duress push button	EA	-	-
Watch tour push button	EA	-	-
Request to exit motion detector	EA	-	-
Motion detector	EA	-	-
Proximity/keypad combination reader	EA	-	-
Proximity card reader	EA	-	-
Request to exit push button	EA	-	-
Paging speaker	EA	-	-
Paging horn	EA	-	-
Talk through communicator	EA	-	-
Interior camera w/detention style housing w/heater	EA	-	-
Interior camera w/detention style housing	EA	-	-
Pan/tilt/zoom camera	EA	-	-
Provide conduit/pullstring for future camera	EA	-	-
Video visitation station	EA	-	-
Video visitation station rough-in only	EA	-	-
Video arraignment station	EA	-	-
Call push button	EA	-	-
TV receptacle control	EA	-	-
CCTV monitor	EA	-	-
DVR remote viewing computer	EA	-	-
CCTV VCR	EA	-	-
Touch screen control station	EA	-	-
Mobile control unit	EA	-	-
A/B audio & video switch	EA	-	-
Wireless access point	EA	-	-
CCTV control keyboard	EA	-	-
Door release push button	EA	-	-
Lighting control	EA	-	-
Lighting control cell group	EA	-	-
Dayroom phone control - by group	EA	-	-
SMS/access server computer	EA	-	-

Misc. Security System Total:	-
-------------------------------------	---